

REVISION HISTORY			
REV	DESCRIPTION	DATE	APPROVED
-	DCN 41326	05/15	STW

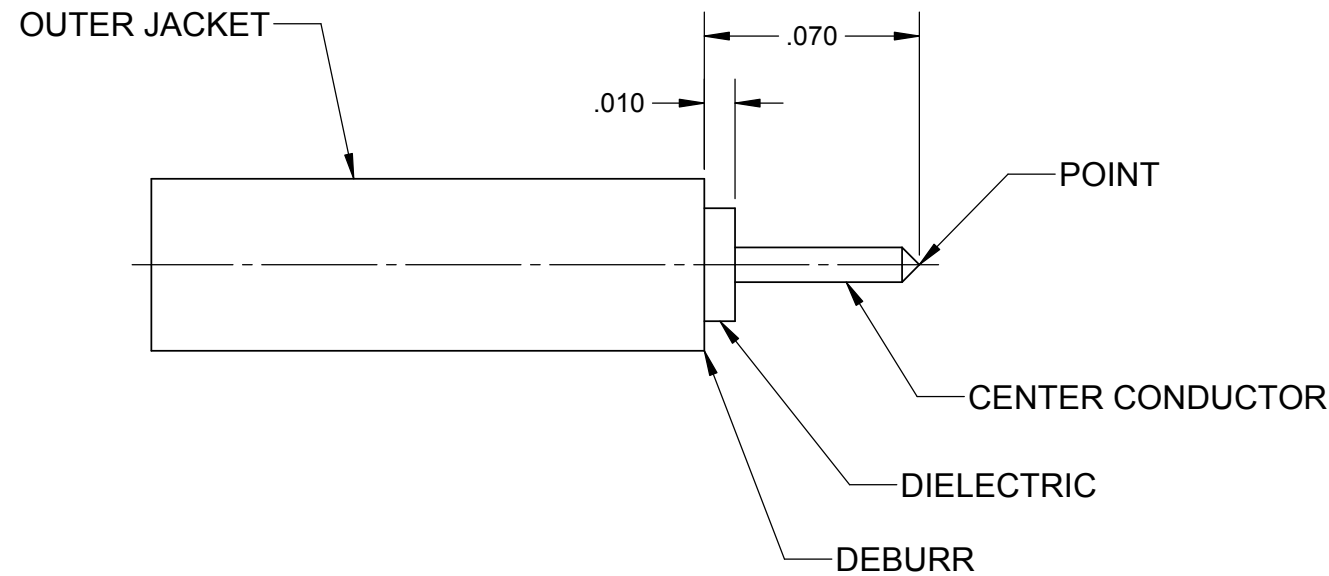

STEP 1.
 TRIM CABLE TO DIMENSIONS SHOWN. BE CAREFUL NOT TO NICK CENTER CONDUCTOR. TRIM CABLE JACKET BACK AT LEAST 0.075" WHEN APPLICABLE.

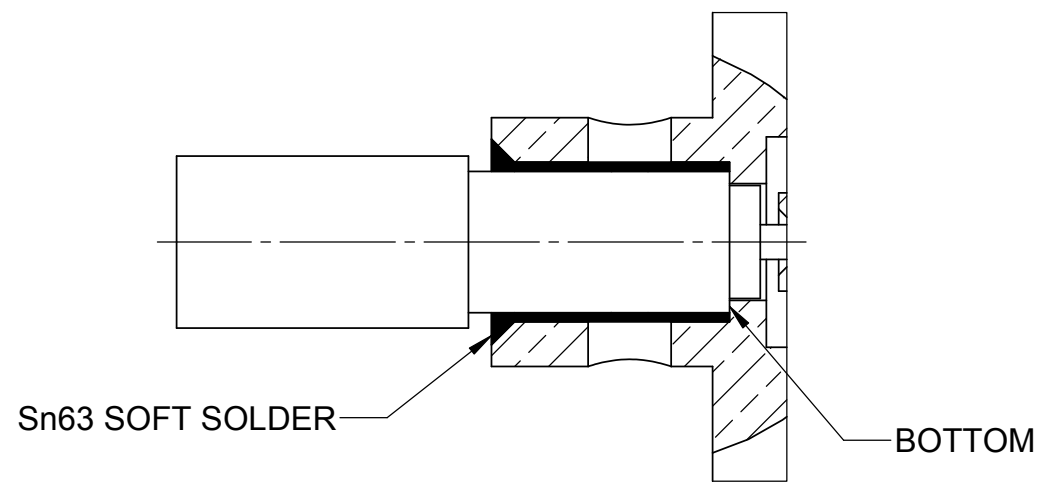

STEP 2.
 INSERT TRIMMED CABLE INTO REAR PORTION OF THE CONNECTOR ASSEMBLY. HOLDING SECURELY, SOFT SOLDER CABLE TO CONNECTOR USING Sn63 SOFT SOLDER.

MATERIAL: PER BOM	DIMENSIONS ARE IN INCHES TOLERANCES:	UNLESS OTHERWISE SPECIFIED	SV Microwave, Inc. 2400 Centrepark West Drive, Suite 100 West Palm Beach, FL 33409 TITLE: CABLE ASSEMBLY INSTRUCTIONS
FINISH: PER BOM	FRACTIONAL: $\pm 1/64$ ANGULAR: X° $\pm 1'0"$ X°X' $\pm 15'$	1) ALL DIMENSIONS ARE AFTER PLATING. 2) BREAK CORNERS & EDGES .005 R. MAX. 3) CHAM. 1ST & LAST THREADS. 4) SURFACE ROUGHNESS 63 $\sqrt{\text{MIL-STD-10}}$. 5) DIA.'S ON COMMON CENTERS TO BE CONCENTRIC WITHIN .004 T.I.R. 6) REMOVE ALL BURRS	
SURFACE AREA: N/A	DECIMAL: X $\pm .030$.XX $\pm .010$.XXX $\pm .005$	INTERPRET DIMENSIONS AND TOLERANCES PER ASME Y14.5M - 1994	DRAWN: BNK 05/11/15 CHECKED: STW 05/11/15 APPROVED: STW 05/11/15 E.M. SIMULATION: N/A
PROPRIETARY THE INFORMATION CONTAINED IN THIS DRAWING IS THE SOLE PROPERTY OF SV MICROWAVE, INC. ANY REPRODUCTION IN PART OR AS A WHOLE WITHOUT THE WRITTEN PERMISSION OF SV MICROWAVE, INC IS PROHIBITED.	THIRD ANGLE PROJECTION 	DWG. NO. 300-32-043 SCALE: N/A	SIZE B CAGE CODE 95077
3221-40019 USED ON:			SHEET 1 OF 1