

PRODUCT DATA DRAWING

REVISION HISTORY			
REV	DESCRIPTION	DATE	APPROVED
C	DCN 51650	05/22	SEE PDM

MATERIALS:

- INSULATORS:PTFE PER ASTM D1710, TYPE 1, GRADE 1, CLASS B.
- SLEEVE:STAINLESS STEEL PER AMS-5640, ALLOY UNS S30300, TYPE 303, COND. A
- BODY & CONTACT:BERYLLIUM COPPER PER ASTM B196, ALLOY C17300, COND. TD04
- SHRINK TUBING:POLYOLEFIN PER SAE AMS-DTL-23053/5-105-0

FINISHES:

- BODIES & CONTACT:GOLD PER ASTM B488, TYPE II, GRADE C, CLASS 1.27 OVER NICKEL PER AMS-QQ-N-290 CLASS 1, .00005" MIN.

ELECTRICAL:

- IMPEDANCE:50 OHMS
- FREQ. RANGE:DC TO 3 GHz
- INSUL. RES.:5,000 MEGOHMS MIN.
- D.W.V:1,000 VRMS MIN.
- VSWR:1.20 + .04 X F IN GHz
- INSERTION LOSS:.11 X SQUARE ROOT OF F(GHz)
- (MAX FREQ. CAN BE LIMITED BY CABLE)

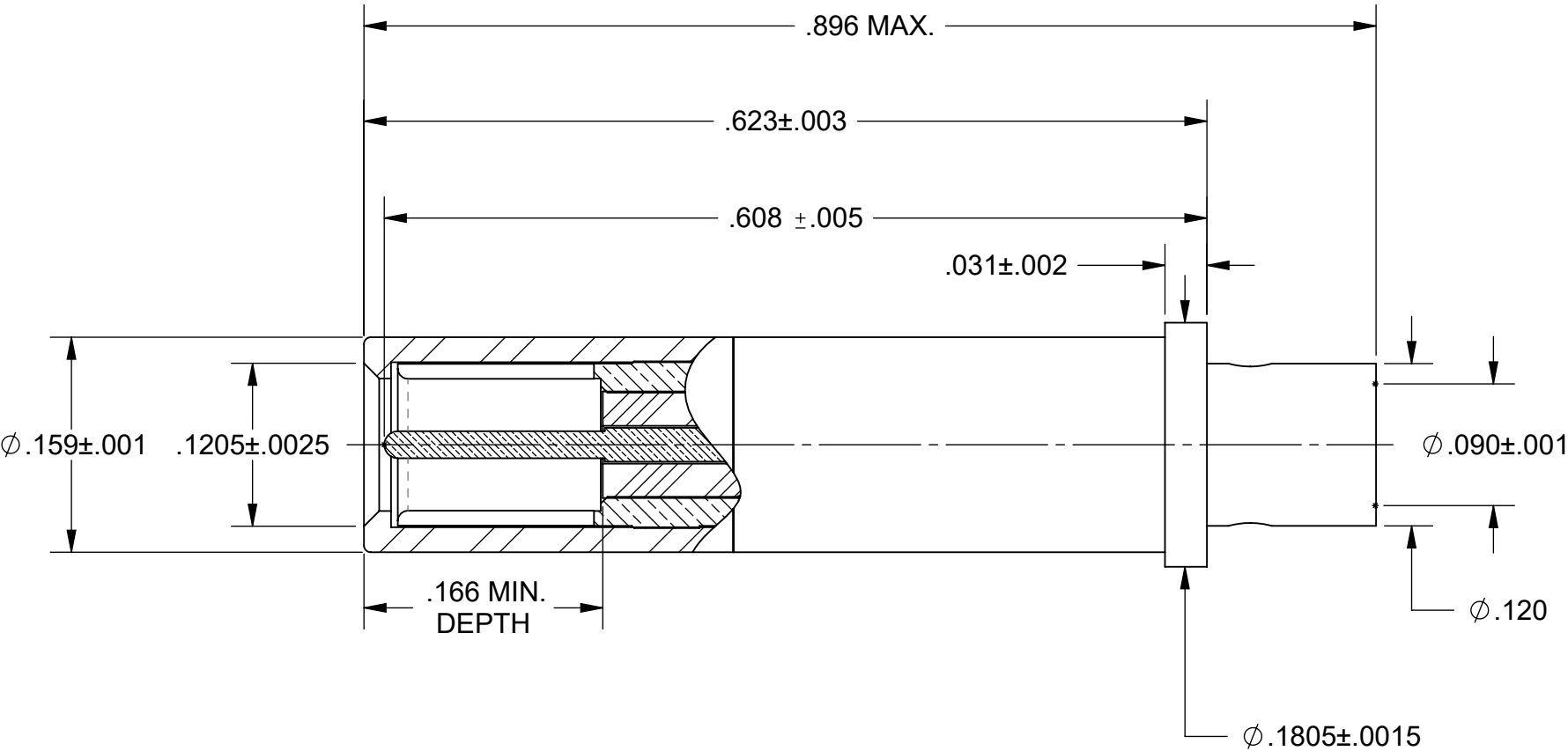

NOTE:
1. ALL SOCKET CONTACTS DESIGNED FOR SERIES I, III OR IV.

REF. AS39029/103 &
MIL-DTL-38999 SERIES III

MATERIAL: SEE NOTES	DIMENSIONS ARE IN INCHES TOLERANCES: FRACTIONAL: ±1/64 ANGULAR: X° ±1°0' X°X' ±15' DECIMAL: .X ±.030 .XX ±.010 .XXX ±.005 INTERPRET DIMENSIONS AND TOLERANCES PER ASME Y14.5M - 1994	UNLESS OTHERWISE SPECIFIED 1) ALL DIMENSIONS ARE IN INCHES (MILLIMETERS) 2) ALL DIMENSIONS ARE AFTER PLATING. 3) BREAK CORNERS & EDGES .005 R. MAX. 4) CHAM. 1ST & LAST THREADS. 5) SURFACE ROUGHNESS 63-MIL-STD-10. 6) DIA.'S ON COMMON CENTERS TO BE CONCENTRIC WITHIN .005 T.I.R. 7) REMOVE ALL BURRS	<div>SVMICROWAVEAmphenolwww.svmicrowave.com</div> <div>TITLE: SIZE 12 SOCKET FOR T-FLEX 405 CABLE</div>	
FINISH: SEE NOTES				
SURFACE AREA: N/A	THIRD ANGLE PROJECTION 	DRAWN: VMJ 11/30/04 CHECKED: SEE PDM APPROVED: SEE PDM	SIZE DWG. NO. 8001-4104 SCALE: 8:1 SHEET 1 OF 1	
PROPRIETARY THE INFORMATION CONTAINED IN THIS DRAWING IS THE SOLE PROPERTY OF SV MICROWAVE, INC. ANY REPRODUCTION IN PART OR AS A WHOLE WITHOUT THE WRITTEN PERMISSION OF SV MICROWAVE, INC IS PROHIBITED.				