

PRODUCT DATA DRAWING

REVISION HISTORY			
REV	DESCRIPTION	DATE	APPROVED
-	DCN 48983	3/25	SEE PDM

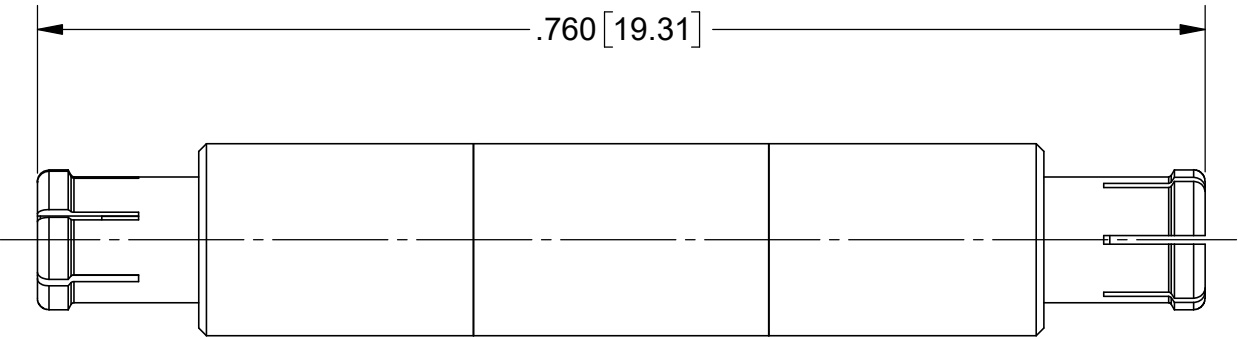

MATERIAL:	
BODIES & CONTACT:	BERYLLIUM COPPER PER ASTM B196, ALLOY No. UNS C17300, TD04.
INSULATOR:	PTFE PER ASTM D1710, TYPE I, GRADE 1, CLASS B.
FINISH:	
CONTACT:	GOLD PER ASTM B488, TYPE II, CODE C, CLASS 1.27, OVER NICKEL PER AMS-QQ-N-290, CLASS 1, .00005" MIN.
PERFORMANCE:	
IMPEDANCE:	50 OHMS
FREQ. RANGE:	DC TO 18.0 GHz.
VSWR:	1.30:1 MAX. DC TO 18.0 GHz.

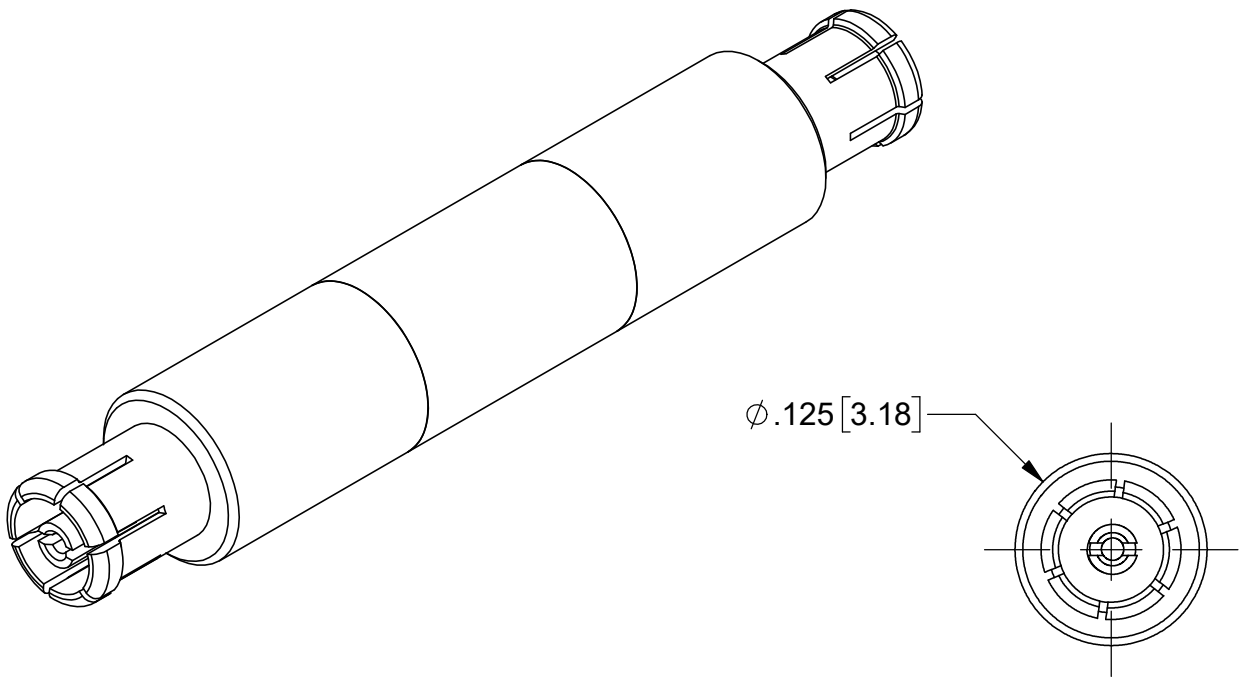
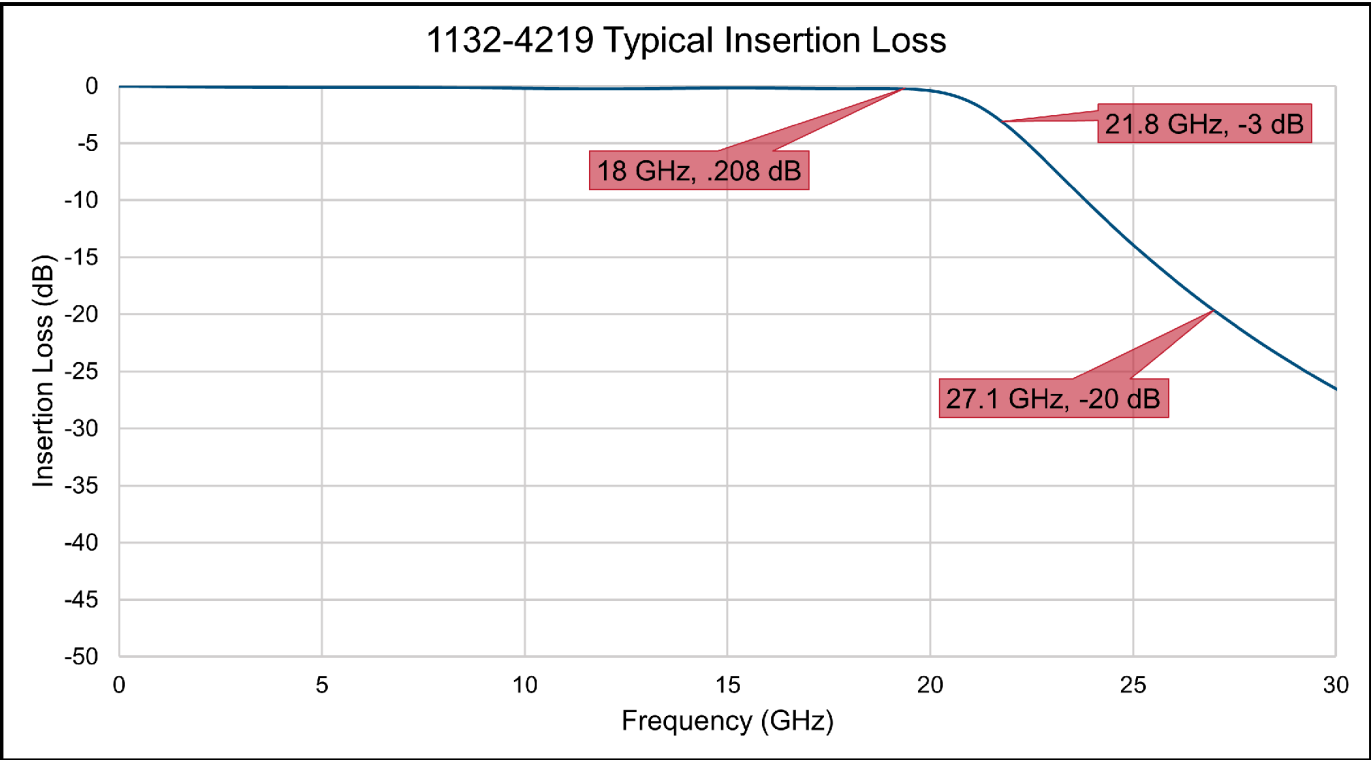

MATERIAL:	SEE NOTES	DIMENSIONS ARE IN INCHES TOLERANCES: FRACTIONAL: ±1/64 ANGULAR: X° ±1°0'
-----------	-----------	---