

PRODUCT DATA DRAWING

REVISION HISTORY			
REV	DESCRIPTION	DATE	APPROVED
-	REL. DCN 35469	10/25/07	STW
A	REV. DCN 51348	02/03/22	STW

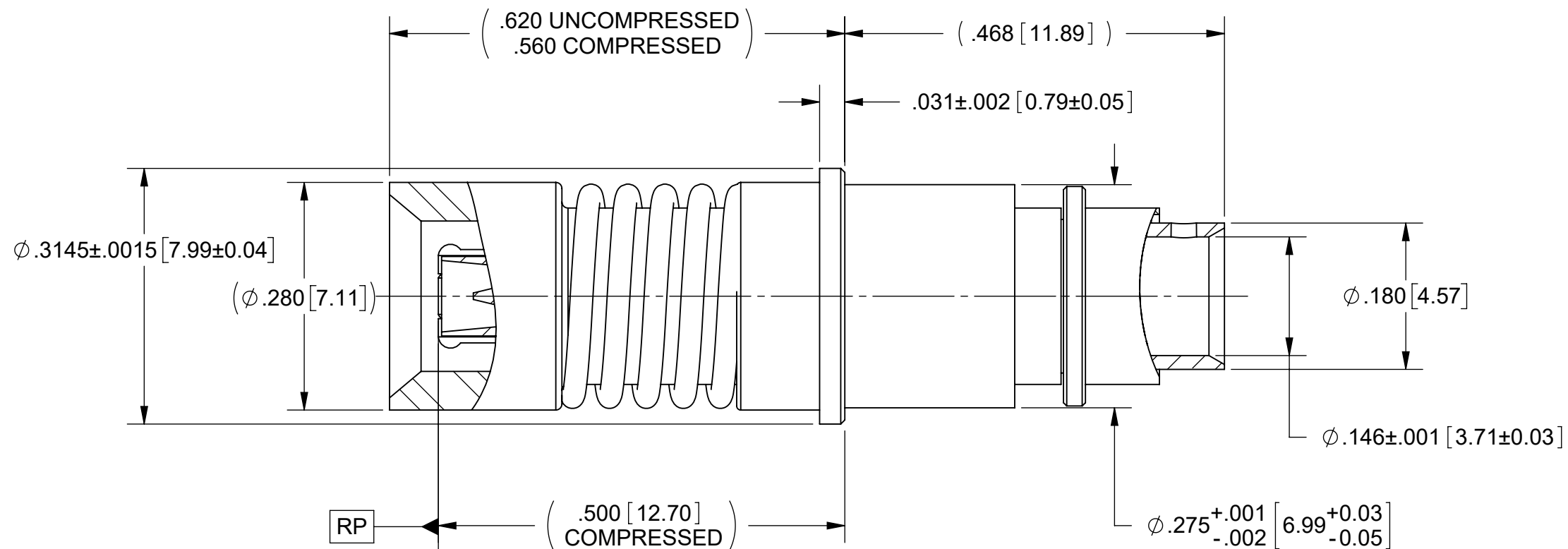

MATERIAL:

BODY & SLEEVE: STAINLESS STEEL PER AMS 5640, ALLOY UNS S30300, TYPE 1 OR ATSM A582, TYPE 303, CONDITION A.
FERRULE: BRASS PER ASTM B16 ALLOY UNS No. 36000.
CONTACT: BERYLLIUM COPPER PER ASTM B196, ALLOY No. UNS C17300, TD04.
LOCK RING: BERYLLIUM COPPER PER ASTM B194, B196 OR B197, ALLOY No. UNS C17200 OR C17300.
INSULATOR: PTFE PER ASTM D1710, TYPE I, GRADE 1, CLASS B.
GASKET: SILICONE RUBBER PER A-A-59588, CLASS 2B, GRADE 60/70
SPRING: STAINLESS STEEL PER ASTM A313, TYPE 302.

FINISH:

BODY, SLEEVE & SPRING: PASSIVATED PER AMS 2700.
CONTACT & FERRULE: GOLD PER ASTM B488, TYPE II, CODE C, CLASS 1.27 OVER NICKEL PER AMS-QQ-N-290, CLASS 1, .00005" MIN.
LOCK RING: NICKEL PER AMS-QQ-N-290.

PERFORMANCE:

IMPEDANCE: 50 OHMS
FREQ. RANGE: DC TO 18.0 GHz
VSWR: 1.25:1 MAX. MATED PAIR DC TO 18.0 GHz
INSERTION LOSS: .06 X SQRT(F(F IN GHz))
DWV: 1000 VRMS
OPERATING TEMP.: -55°C TO +125°C

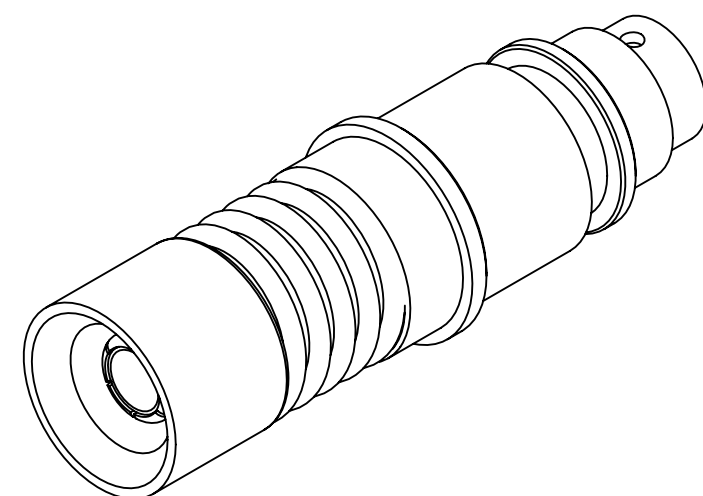

MATERIAL: SEE NOTES	DIMENSIONS ARE IN INCHES TOLERANCES: FRACTIONAL: ±1/64 ANGULAR: X° ±1'0" X'X' ±15'	UNLESS OTHERWISE SPECIFIED 1) ALL DIMENSIONS ARE IN INCHES (MILLIMETERS) 2) ALL DIMENSIONS ARE AFTER PLATING. 3) BREAK CORNERS & EDGES .005 R. MAX. 4) CHAM. 1ST & LAST THREADS. 5) SURFACE ROUGHNESS ⁶³ MIL-STD-10. 6) DIA.'S ON COMMON CENTERS TO BE CONCENTRIC WITHIN .005 T.I.R. 7) REMOVE ALL BURRS	SV Microwave, Inc. 2400 Centrepark West Drive, Suite 100 West Palm Beach, FL 33409
FINISH: SEE NOTES	DECIMAL: X ±.030 .XX ±.010 .XXX ±.005	INTERPRET DIMENSIONS AND TOLERANCES PER ASME Y14.5M - 1994	TITLE: 18 GHZ BMZ MALE TO RG-402 FOR M38999 SIZE 8 CAVITY
SURFACE AREA: N/A	THIRD ANGLE PROJECTION	DRAWN: JMC 10/25/07	SIZE: B CAGE CODE: 95077 DWG. NO.: SF9811-6001
PROPRIETARY THE INFORMATION CONTAINED IN THIS DRAWING IS THE SOLE PROPERTY OF SV MICROWAVE, INC. ANY REPRODUCTION IN PART OR AS A WHOLE WITHOUT THE WRITTEN PERMISSION OF SV MICROWAVE, INC IS PROHIBITED.		CHECKED: STW 10/25/07 APPROVED: STW 10/25/07	SCALE: 6:1 SHEET 1 OF 1